

TOSHIBA

Cradle

Owner's Manual

B-FP802-CR-QM-S

B-FP802-CR4-QM-S

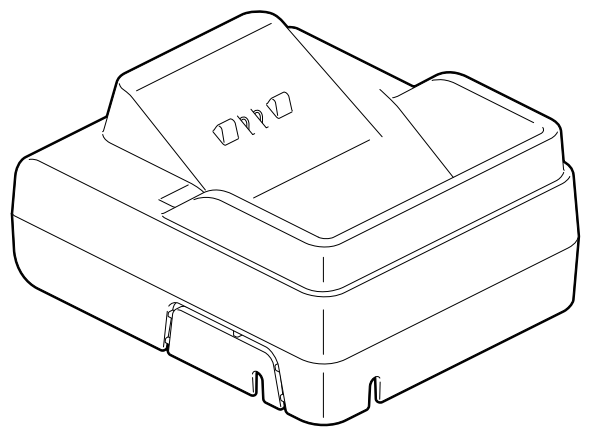

CONTENTS

1. Precautions	3
2. Part Names and Accessories (1-slot Cradle)	5
Part names	5
Accessories	5
3. Part Names and Accessories (4-slot Cradle)	6
Part names	6
Accessories	6
4. Connecting the AC Adapter (1-slot Cradle)	7
5. Connecting the AC Adapter (4-slot Cradle)	9
6. Charging	11
7. Troubleshooting	12
8. Specifications	13
9. When purchasing the power cord	14

1. Precautions

CE Compliance (for EU only)

This product complies with the requirements of EMC Directive including their amendments.

NOTES:

1. This equipment has been tested and found to comply with the limits for a Class A digital device, pursuant to Part15 of the FCC Rules.

These limits are designed to provide reasonable protection against harmful interference when the equipment is operated in a commercial environment.

This equipment generates, uses, and can radiate radio frequency energy and, if not installed and used in accordance with the instruction manual, may cause harmful interference to radio communications.

Operation of this equipment in a residential area is likely to cause harmful interference in which case the user will be required to correct the interference at this own expense.

2. Changes or modification not expressly approved by manufacturer for compliance could void the user's authority to operate the equipment.

This Class A digital apparatus complies with Canadian ICES-003.

Cet appareil numérique de la classe A est conforme à la norme NMB-003 du Canada.

Note:

When you purchase interface cables on the market, shielded cables must be chosen and used.

NOTICE FOR THE CUSTOMERS IN THE UNITED KINGDOM

A moulded plug complying with BS 1363 is fitted to this equipment for your safety and convenience.

Should the fuse in the plug supplied need to be replaced, a 5 AMP fuse approved by ASTA or BSI to BS 1362, (i.e.,

marked  with or  mark) must be used.

If the plug supplied with this equipment has a detachable fuse cover, be sure to attach the fuse cover after you change the fuse. Never use the plug without the fuse cover. If you should lose the fuse cover, please contact your nearest Toshiba Tec service representative.

**WARNING**

This indicates that there is the risk of death or serious injury if the machines are handled improperly or contrary to this indication.

- If water or any other liquid enters the machine, turn off the power. Continuous use of the machine under such conditions may cause fire or electric shock.
- If the enclosure is damaged when dropped or subject to shock, turn off the power. Continuous use of the machine under such conditions may cause fire or electric shock.
- Avoid continuous exposure to direct sunlight or high temperature as this may cause fire.
- Do not remove covers or modify the machine by yourself. Doing so may cause fire or electric shock.
- Avoid water, operation with wet hands or cleaning with a moistened cloth. Failure to do this may cause fire or electric shock.
- Do not wipe the machine with a cloth moistened with thinner or other volatile solvent as this may cause fire or electric shock.
- DO NOT USE a spray cleaner containing flammable gas for cleaning this product, as this may cause a fire.
- The AC adapter and the power cable co-packed with this device must be used.

**CAUTION**

This indicates that there is the risk of personal injury or damage to objects if the machines are improperly handled contrary to this indication.

- Keep away from flame or other sources of heat. Failure to do this may cause fire or machine failure.
- Do not drop or shock the machine as this may cause machine failure. Doing so may cause machine failure.
- During lightning, turn off and keep away from the machine because of danger of electric shock and machine failure.
- Avoid locations subject to rapid change in temperature as this causes condensation, causing electric shock or machine failure.

Precautions:

The following precautions will help to ensure that this machine will continue to function correctly.

- Try to avoid locations that have the following adverse conditions:
 - Temperatures out of the specification
 - High Humidity
 - Direct sunlight
 - Excessive vibration
- The cover should be cleaned by wiping with a dry cloth or a cloth slightly dampened with a mild detergent solution. NEVER USE THINNER OR ANY OTHER VOLATILE SOLVENT on the plastic covers.

CAUTION!

- This manual may not be copied in whole or in part without the prior written permission of TOSHIBA TEC.
- The contents of this manual may be changed without notification.
- Please refer to your local Authorised Service representative with regard to any queries you may have in this manual.

2. Part Names and Accessories (1-slot Cradle)

■ Part names

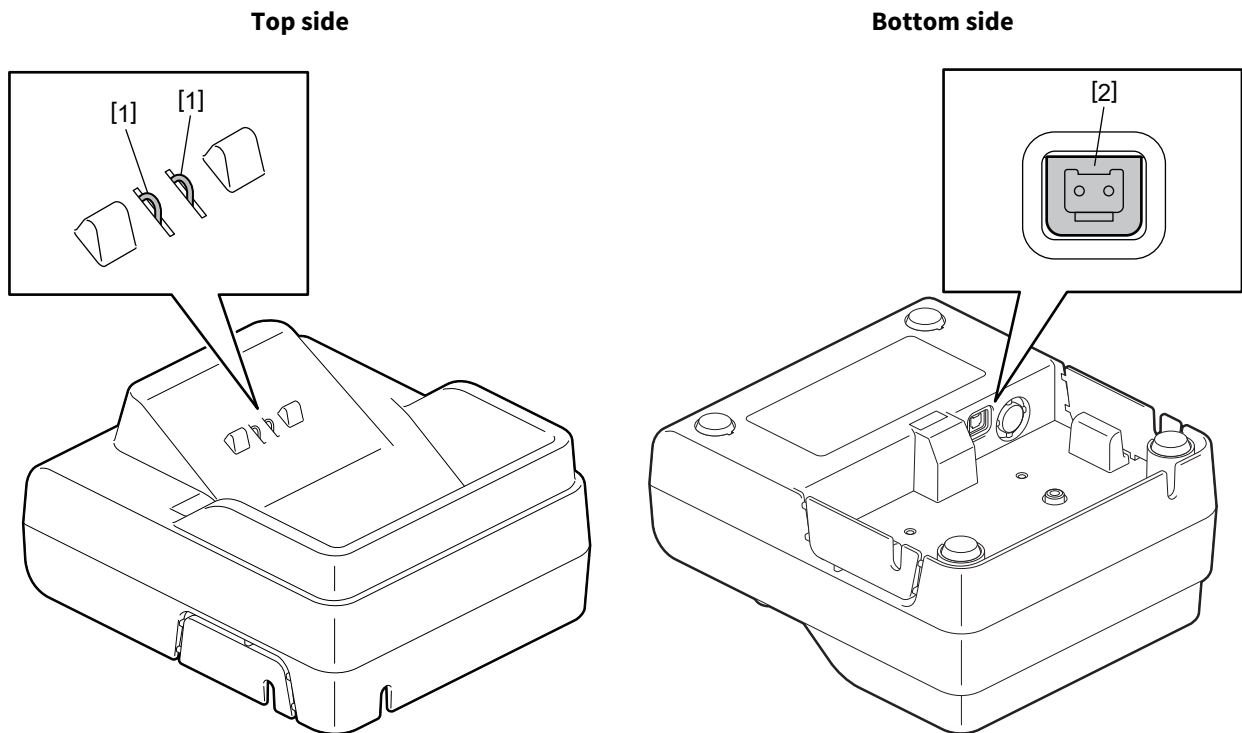

No.	Name	No.	Name
1	Charging terminal	2	ACIN terminal

■ Accessories

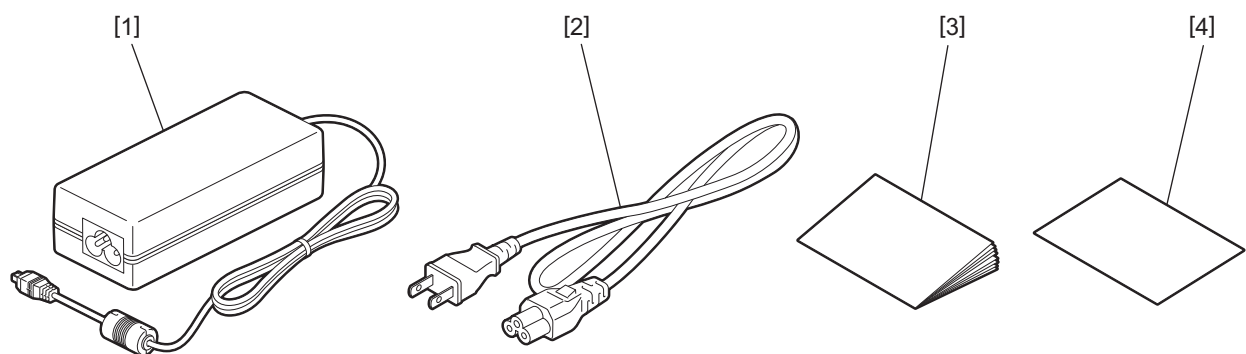

No.	Name	No.	Name
1	AC adapter	3	Owner's Manual
2	Power cable	4	Safety Precaution Sheet

3. Part Names and Accessories (4-slot Cradle)

■ Part names

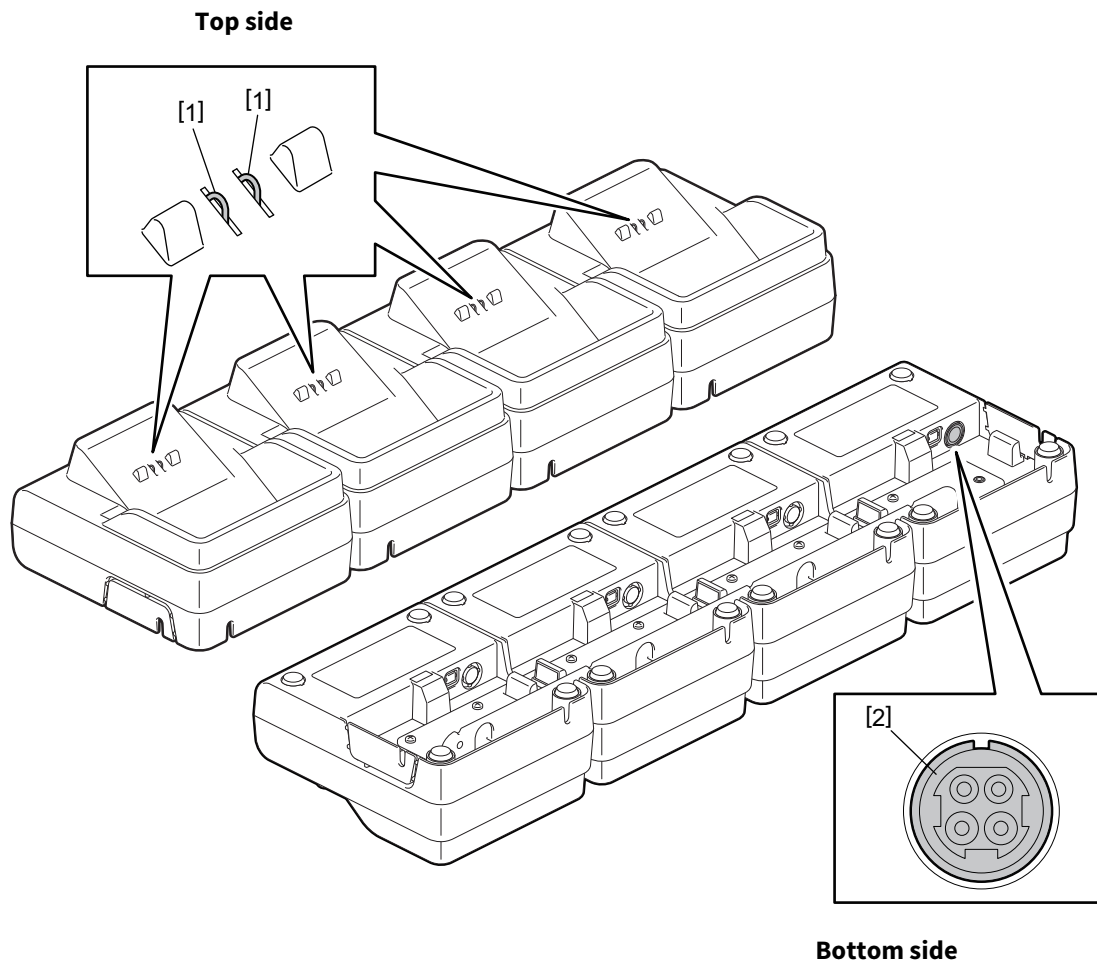

No.	Name	No.	Name
1	Charging terminal	2	ACIN terminal

■ Accessories

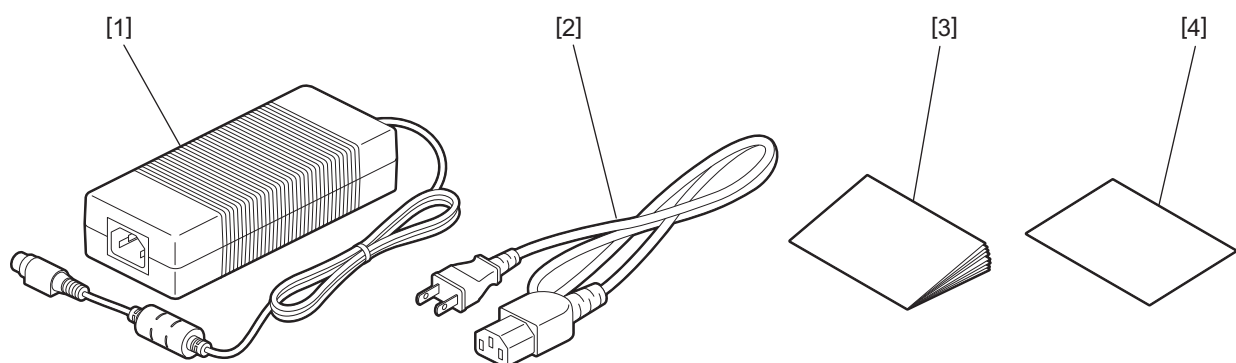

No.	Name	No.	Name
1	AC adapter	3	Owner's Manual
2	Power cable	4	Safety Precaution Sheet

4. Connecting the AC Adapter (1-slot Cradle)

This section describes how to connect the AC adapter to a 1-slot cradle.

- 1 Connect the plug of the AC adapter to the AC IN terminal of the cradle as shown in the figure.**
Orient the side of the plug with an arrow mark to the cradle side.

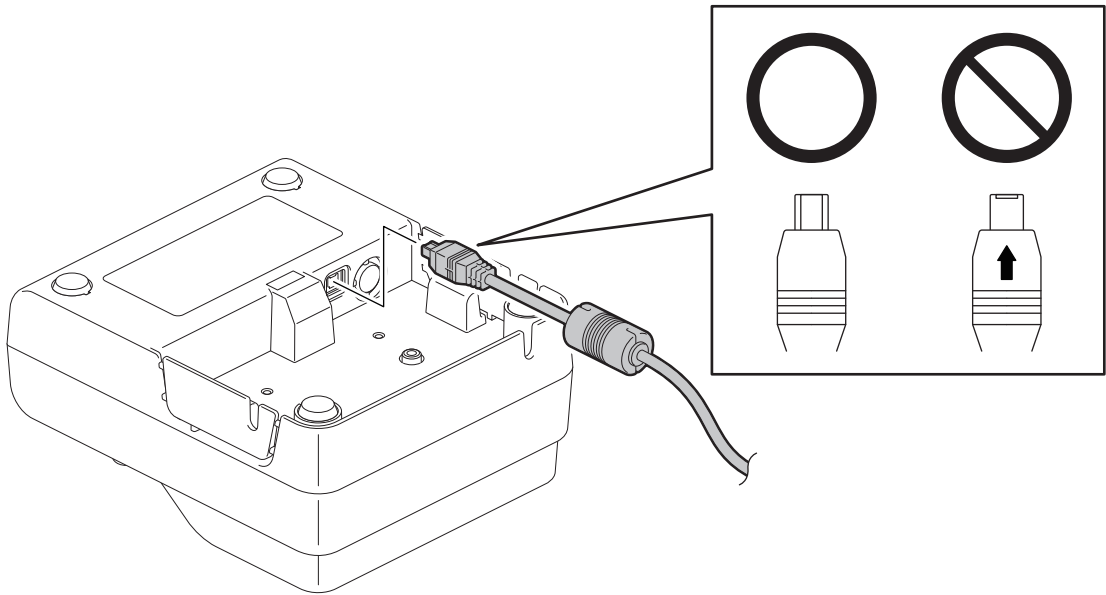

- 2 Wire the cable of the AC adapter as shown in the figure.**

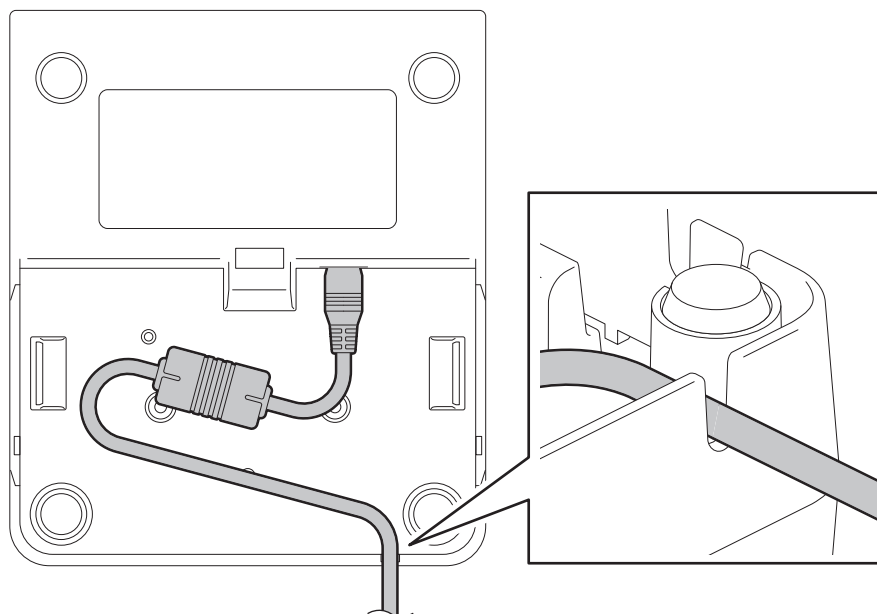

Note

If the wiring of the cable of the AC adapter is improper, it will be caught by the cradle and this may cause a damage.

3 Connect the power cable to the AC adapter.

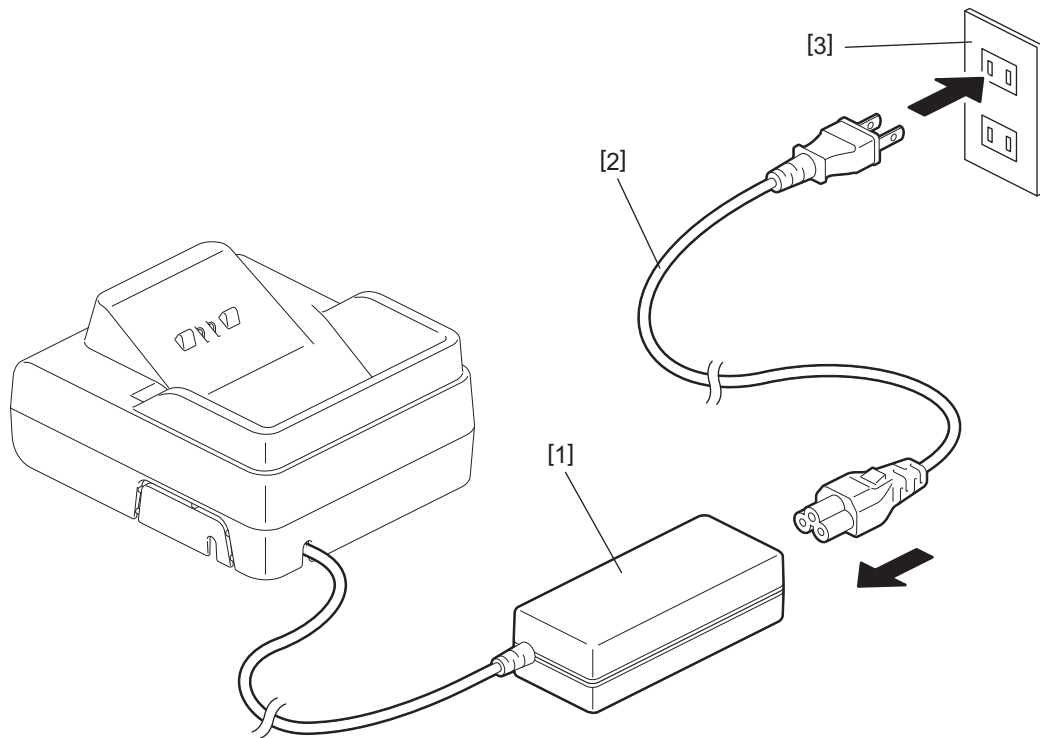

No.	Name
1	AC adapter
2	Power cable
3	AC outlet

5. Connecting the AC Adapter (4-slot Cradle)

This section describes how to connect the AC adapter to a 4-slot cradle.

- 1 Connect the plug of the AC adapter to the AC IN terminal of the cradle as shown in the figure.**
Orient the side of the plug with an arrow mark to the cradle side.

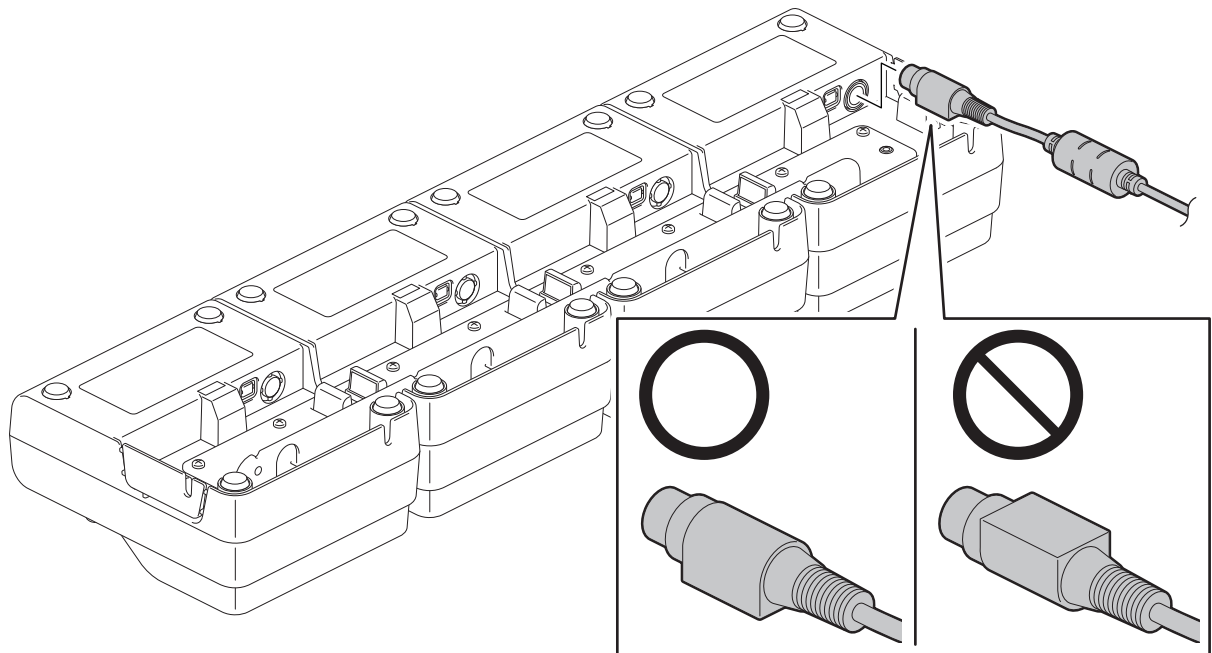

- 2 Wire the cable of the AC adapter as shown in the figure.**

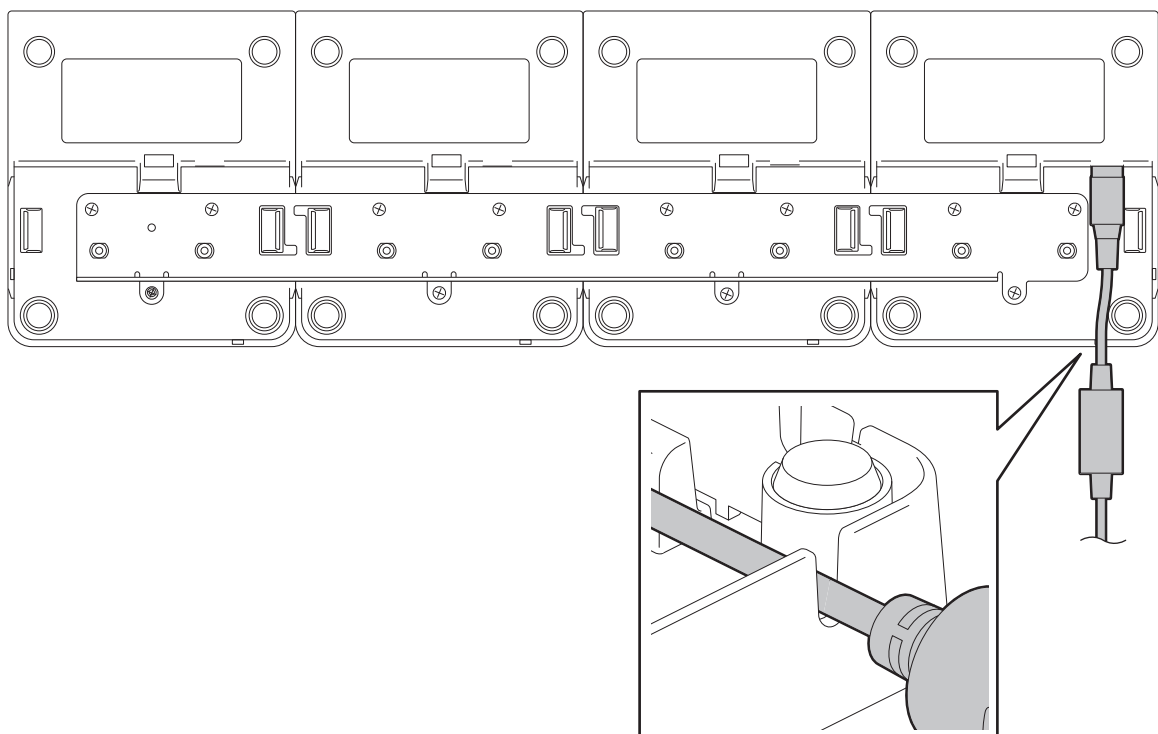

Note

If the wiring of the cable of the AC adapter is improper, it will be caught by the cradle and this may cause a damage.

3 Connect the power cable to the AC adapter.

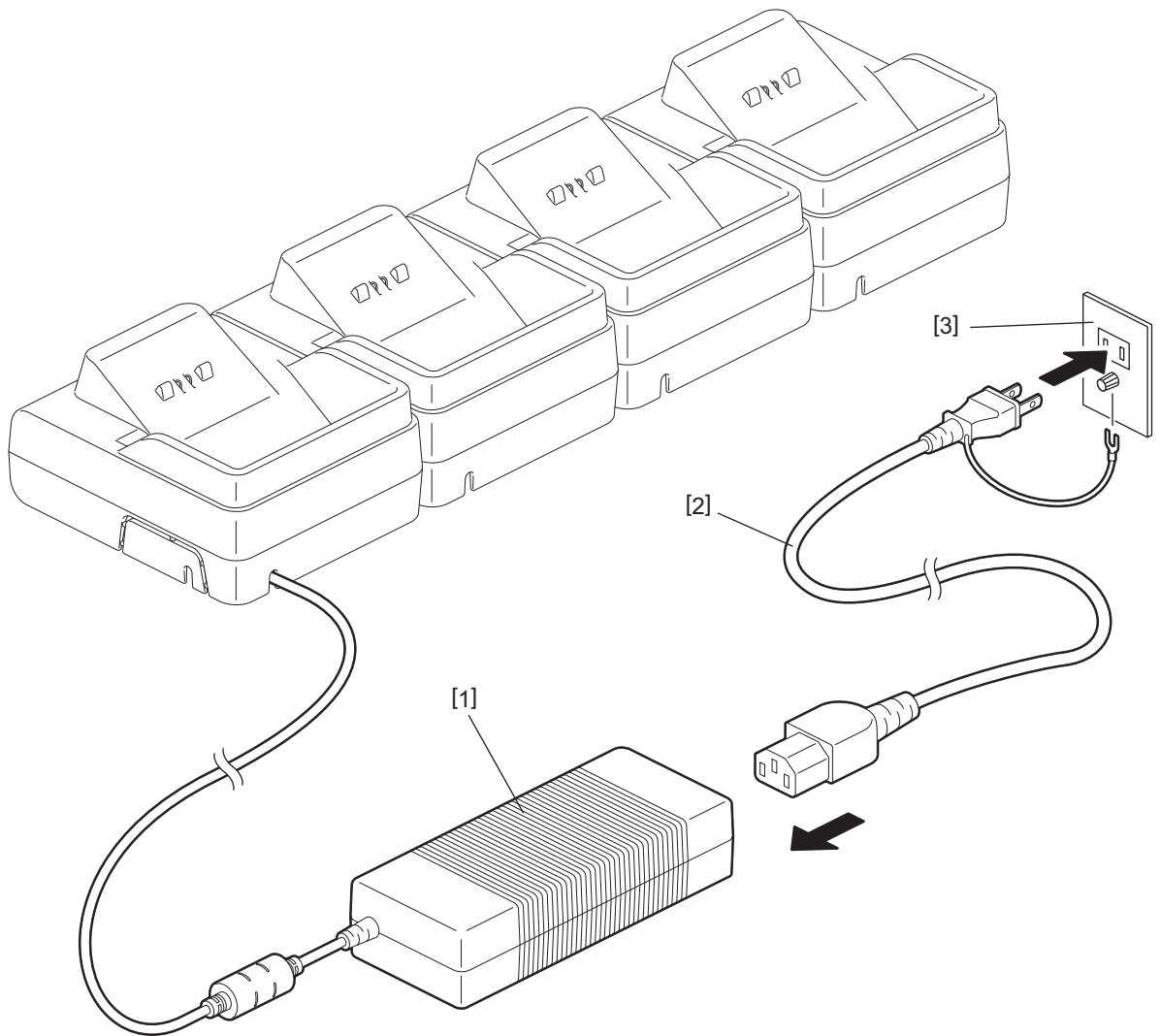

No.	Name
1	AC adapter
2	Power cable
3	AC outlet

6. Charging

Charging is performed by placing a portable printer on the cradle.
This section describes by taking a 1-slot cradle for the explanation purposes.

1 Place the portable printer by aligning its charging terminal [2] to that for [1] the cradle.

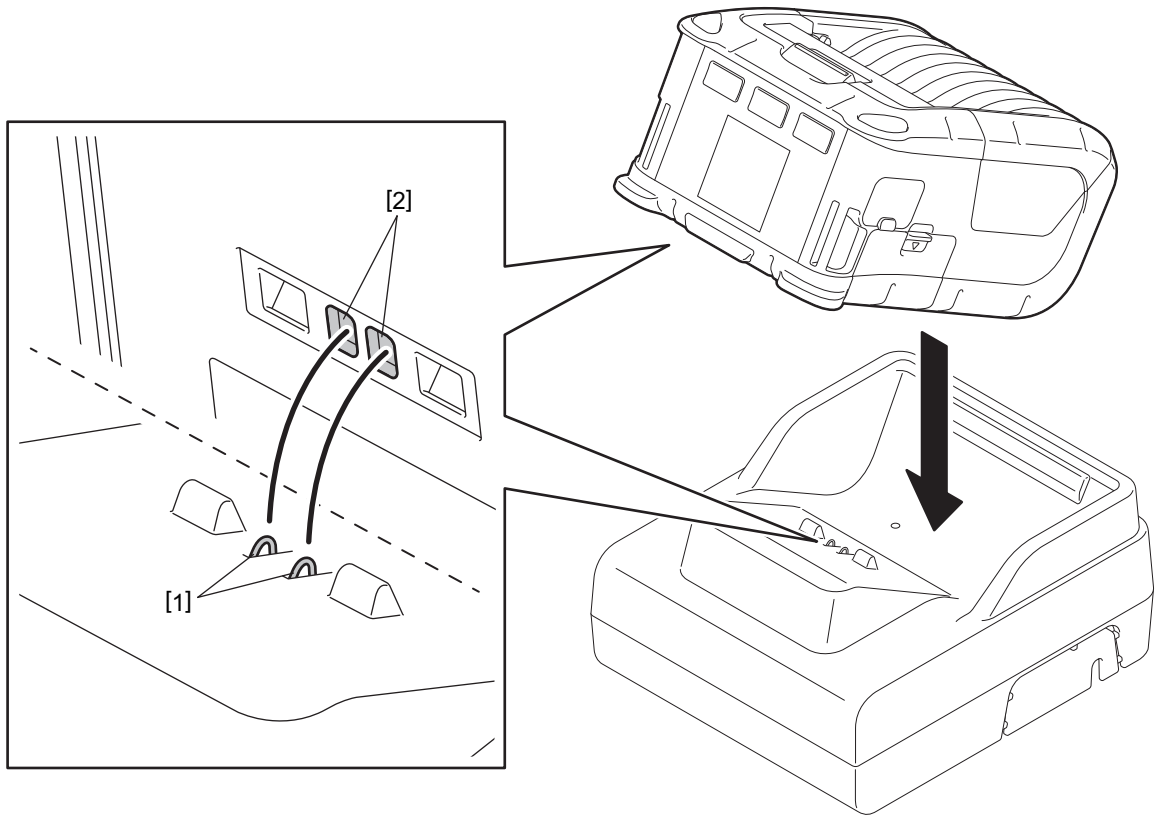

- When installing the printer, make sure there are no foreign objects between the charging terminals and the printer.
- If there is any water droplet or dust on the charging terminals, wipe it off before using.
- Periodically clean the charger terminals with a dry cloth.
- When the charging of the battery pack of the portable printer starts, its CHARGE lamp lights up in orange. When the charging is completed, the CHARGE lamp goes out.
- Do not perform the charging using the DC IN connector of the portable printer when it is placed on the cradle.

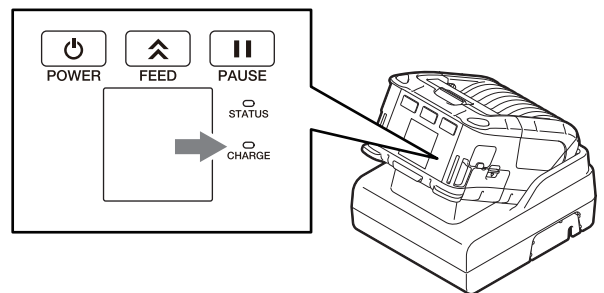

- Up to 4 portable printers can be charged at the same time by using a 4-slot cradle.

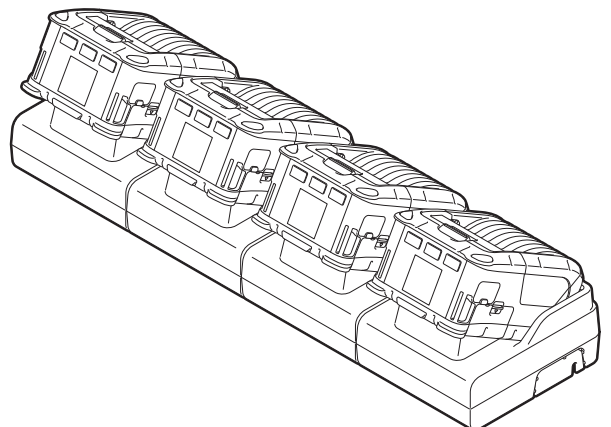

7. Troubleshooting

When a problem occurs during the operation, check the following troubleshooting guide and take the corrective action suggested.

When the problem still persists even if the following solutions have been performed, do not attempt to repair it by yourself.

Disconnect the power cable and then contact a Toshiba Tec service representative for assistance.

In the case of the following symptoms, check the respective points and take corrective action.

Symptom	Point to check (Cause)	Solution
The CHARGE lamp does not light even if a portable printer is placed on the cradle.	<ul style="list-style-type: none">• The portable printer is not placed on the cradle properly.• The power cable or the AC adapter is not connected.• The power cable or the AC adapter is open circuited.	<ul style="list-style-type: none">• Properly place the portable printer so that its charging terminal is aligned to that for the cradle.• Connect the power cable or the AC adapter properly.• If it is open circuited, replace the power cable or the AC adapter with a new one. For a new power cable and AC adapter, contact a Toshiba Tec service representative for assistance.

8. Specifications



















1-slot Cradle





Item	Cradle	AC adapter (Accessory)
Model	B-FP802-CR-QM-S	FSP065-RBBN3
	B-FP802-CR-CN-S	
Power requirements	DC +19V, 3.42A (Supplied by the AC adapter)	100 to 240V AC, 50/60 Hz
Output voltage	-	DC+19V, 3.42A
Application for	TOSHIBA TEC battery pack	TOSHIBA Battery Charger for
	B-FP803-BTH-QM-R	B-EP800-CHG-QM-R
		B-FP802-CR-QM-S
		B-FP802-CR-CN-S
Number of slots	1 slot	-
Operating temperature	0°C to 40°C (32°F to 104°F)	0°C to 40°C (32°F to 104°F)
Operating humidity	20 to 80% (no condensation)	20 to 80% (no condensation)
Storage temperature	-20°C to 60°C (-4°F to 140°F)	-20°C to 60°C (-4°F to 140°F)
Storage humidity	10 to 85% (no condensation)	10 to 85% (no condensation)
Dimensions	120 x 69.5 x 140 mm (w/h/d) 120 x 137.6 x 145.6 mm (w/h/d): With a printer installed	46 x 30 x 108 mm (w/h/d)
Weight	Approx 201 g (7.1oz)	Approx. 250 g (8.8 oz)
Accessories	AC adapter x 1	

4-slot Cradle

Item	Cradle	AC adapter (Accessory)
Model	B-FP802-CR4-QM-S	FSP150-ABAN3
	B-FP802-CR4-CN-S	
Power requirements	DC +19V, 7.89A (Supplied by the AC adapter)	100 to 240V AC, 50/60 Hz
Output voltage	-	DC +19V, 7.89A
Application	TOSHIBA TEC battery pack	TOSHIBA Battery Charger for
	B-FP803-BTH-QM-R	B-EP800-CHG6-QM-R
		B-FP802-CR4-QM-S
		B-FP802-CR4-CN-S
Number of slots	4 slot	-
Operating temperature	0°C to 40°C (32°F to 104°F)	0°C to 40°C (32°F to 104°F)
Operating humidity	20 to 80% (no condensation)	20 to 80% (no condensation)
Storage temperature	-20°C to 60°C (-4°F to 140°F)	-20°C to 60°C (-4°F to 140°F)
Storage humidity	10 to 85% (no condensation)	10 to 85% (no condensation)
Dimensions	480 x 69.5 x 140 mm (w/h/d) 480 x 137.6 x 145.6 mm (w/h/d): With a printer installed	72 x 40 x 171mm (w/h/d)
Weight	Approx 1080 g (38.1oz)	Approx 800g (28.2 oz)
Accessories	AC adapter x 1	

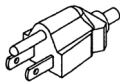
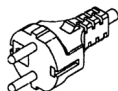
9. When purchasing the power cord

Country	Agency	Certification mark	Country	Agency	Certification mark	Country	Agency	Certification mark
Australia	SAA		Germany	VDE		Sweden	SEMKKO	
Austria	OVE		Ireland	NSAI		Switzerland	SEV	
Belgium	CEBEC		Italy	IMQ		UK	ASTA	
Canada	CSA		Japan	METI		UK	BSI	
Denmark	DEMKO		Netherlands	KEMA		U.S.A.	UL	
Finland	FEI		Norway	NEMKO		Europe	HAR	
France	UTE		Spain	AEE		China	CCC	

Power Cord Instruction					
1. For use with 100 – 125 Vac mains power supply, please select a power cord rated Min. 125V, 10A.					
2. For use with 200 – 240 Vac mains power supply, please select a power cord rated Min. 250V.					
3. Please select a power cord with the length of 2m or less.					
Country/Region	North America	Europe	United Kingdom	Australia	China
Power Cord					
Rated (Min.) Type	125V, 10A SVT	250V H05VV-F	250V H05VV-F	250V AS3191 approved, Light or Ordinary Duty type	250V GB5023
Conductor size (Min.)	No. 3/18AWG	3 x 0.75 mm ²	3 x 0.75 mm ²	3 x 0.75 mm ²	3 x 0.75 mm ²
Plug Configuration (locally approved type)					
Rated (Min.)	125V, 10A	250V, 10A	250V, *1	250V, *1	250V, *1

*1 At least, 125% of the rated current of the product.

Cradle

Owner's Manual

B-FP802-CR-QM-S

B-FP802-CR4-QM-S

Toshiba Tec Corporation

1-11-1, OSAKI, SHINAGAWA-KU, TOKYO, 141-8562, JAPAN

© 2019 Toshiba Tec Corporation All rights reserved

PRINTED IN INDONESIA
Ver01 F EO0133130